

COMMERCIAL - COMBINED TOWNSHIPS

MAP #	CLASS	STUDY	PARCEL NO.	LOCATION	SALE DATE	ACRE	VALUE	COMMENTS
1	COM		18-018-094-00	142ND		0.51	\$16,515	BROEKHUIS PLUMBING
2	COM		18-018-099-00	142ND		0.64	\$16,687	OVERISEL EMPORIUM
3	COM		18-005-033-10	44TH		0.84	\$22,078	HOLLAND SCREEN PRINT
4	COM		09-005-026-20	134TH		3.01	\$98,274	CRYSTAL FLASH
5	COM		18-018-026-00	48TH		3.22	\$105,316	AUTO PARTS
6	COM		18-018-026-10	48TH		5.09	\$49,321	AUTO PARTS
7	COM		18-012-019-00	144TH		6.47	\$88,785	VANDAM/HUNGRY FOR CHRIST
8	COM		18-020-016-20	45TH ST		6.66	\$90,047	WEDEVEN BROS
9	COM		09-005-026-11	134TH		7.40	\$148,050	PROFILE STORAGE UNITS (M-40)
10	SALE-COM		18-018-026-00	48TH ST	2/9/17	9.24	\$195,239	AUTO PARTS
11	COM		09-006-062-00	47TH		23.16	\$181,590	RIVERVIEW MH PARK
12	COM	574	18-576-008-00	M-40		0.37	\$30,800	PAYBACK
13	SALE-COM		09-550-012-00	M-40	7/24/18	0.05	\$15,555	JOMAR - HAPPY PAWS
14	COM		09-006-039-10	M-40		0.09	\$4,116	JOMAR
15	SALE-COM		09-550-008-00	M-40	6/3/19	0.11	\$4,000	VACANT LAND
16	COM		09-006-055-00	M-40		0.13	\$23,100	CHMIELEWSKI
17	COM	574	18-756-008-10	M-40		0.28	\$14,772	PAYBACK VACANT
18	COM		18-031-012-10	M-40		0.31	\$13,062	HOP FAMILY
19	SALE-COM		09-070-001-00	M-40	9/9/19	0.37	\$17,762	WELCHER ENTERPRISES
20	COM		09-005-024-70	M-40		0.40	\$18,311	HAWKEYE COMPUTERS
21	COM		18-405-003-00	M-40		0.45	\$23,262	BLISS BAKERY
22	SALE-COM		18-120-009-00	M-40	3/2/18	0.55	\$76,012	APARTMENTS - 2 PARCELS
23	SALE-COM		18-120-008-00	M-40	3/2/18	0.61	\$59,509	APARTMENTS - 2 PARCELS
24	COM		18-031-021-02	M-40		0.67	\$34,992	JOMAR VACANT
25	COM		18-031-021-02	M-40		0.67	\$34,992	JOMAR (NEXT TO HEATING)
26	COM		18-031-026-00	M-40		0.73	\$27,832	PAYBACK MORTUARY
27	COM		09-006-119-20	M-40		0.76	\$34,601	DOLLAR GENERAL
28	COM		09-006-119-10	M-40		0.91	\$41,433	AUTO VALUE
29	SALE-COM		18-120-008-00	M-40	7/31/20	1.16	\$141,566	APARTMENTS - 4 PARCELS
30	SALE-COM		18-031-026-00	M-40	11/28/20	1.48	\$55,340	PAYBACK PROPERTIES - 3 PARCELS
31	SALE-COM		09-017-022-00	M-40	9/20/18	2.80	\$57,248	PREFERRED DEVELOPMENT
32	SALE-COM		09-017-025-00	M-40	9/20/18	2.83	\$87,626	PREFERRED DEVELOPMENT
33	SALE-COM		09-006-040-84	M-40	6/18/19	3.06	\$120,000	HAWKEYE STORAGE
34	COM		09-008-008-00	M-40		3.18	\$83,213	BKV - VACANT LAND
35	SALE-COM		09-008-012-00	M-40	9/15/21	4.42	\$195,239	HAMLAND * INCLUDES P.P.
36	COM		09-008-005-10	M-40		4.86	\$126,900	BKV - PARKING LOT
37	COM		09-016-019-01	M-40		26.18	\$205,232	LUGTEN VACANT LAND

"COM" PARCELS ARE FROM ALLEGAN COUNTY APPRAISAL STUDY

COMMERCIAL M-40 < 1 ACRE

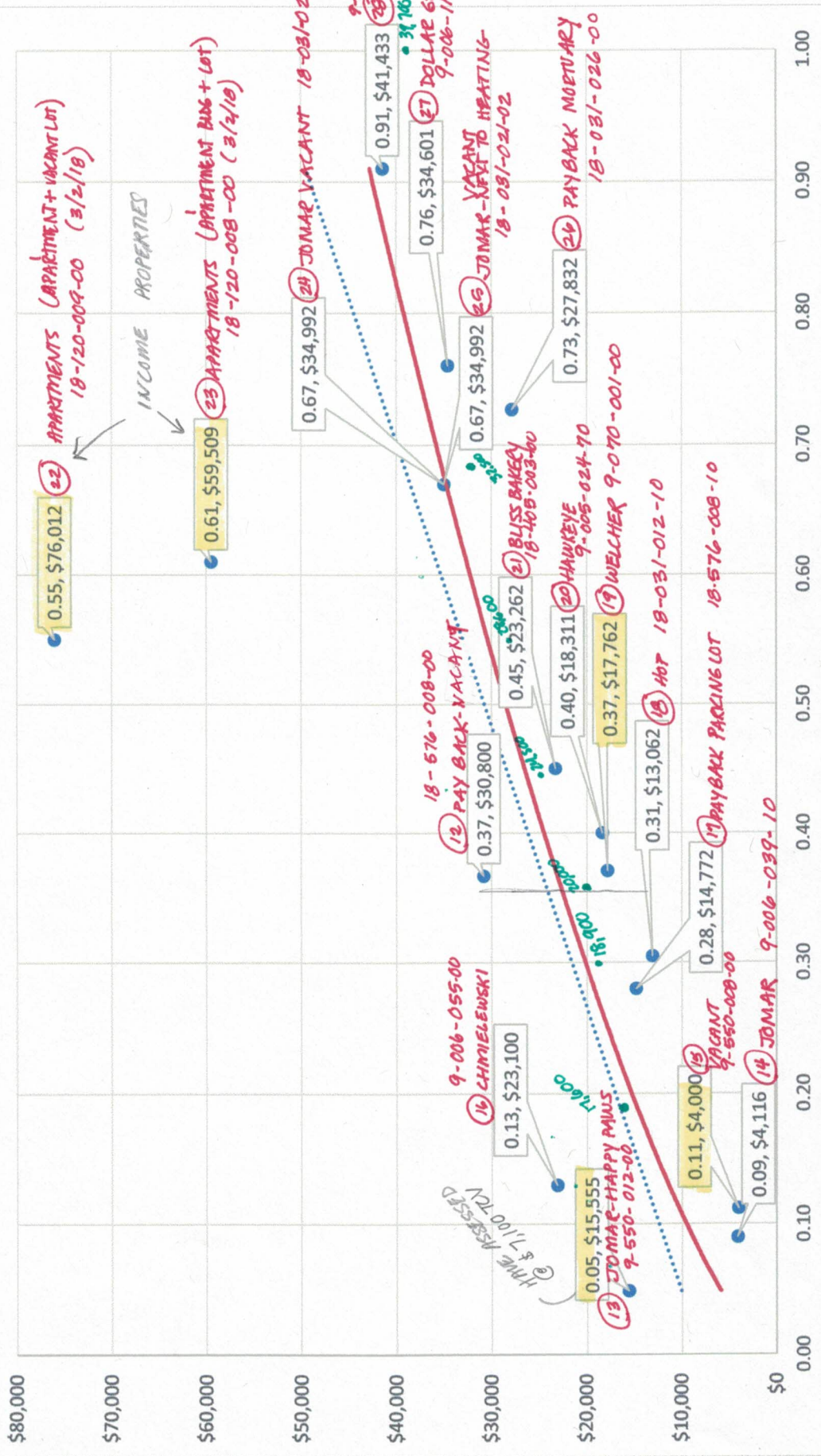

* 2021

* HIGHLIGHTED PARCELS ARE SALES

COMMERCIAL M-40 > 1 ACRE

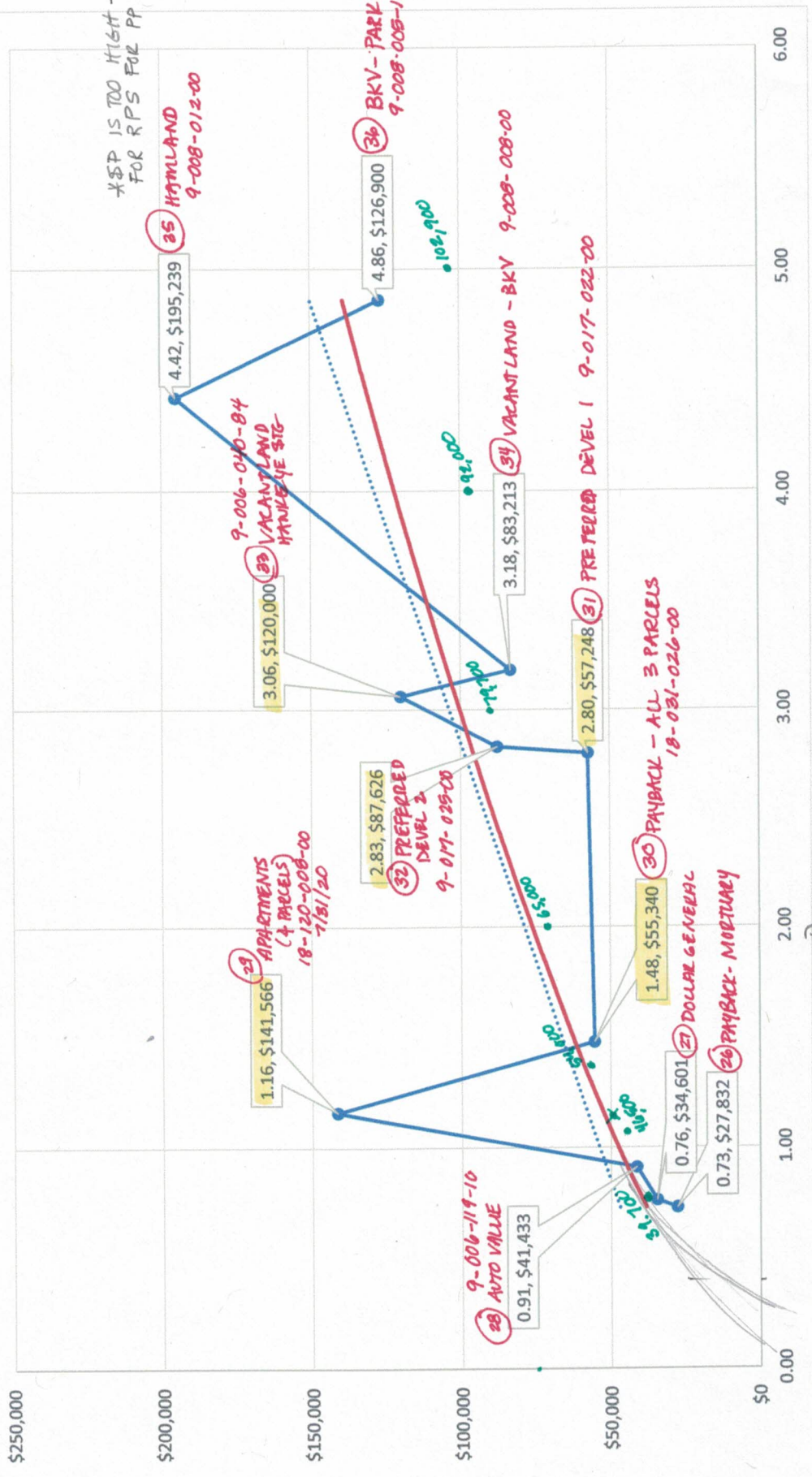

*SP IS TOO HIGH - WAITING FOR RPS FOR PP VALUE

#37 26.18 AC \$205,232 VACANT LAND LUGTEN 9-016-019-01

9 PROFILE STORAGE 9-005-026-11

* HIGHLIGHTED PARCELS ARE FROM EQUALIZATION STUDY

43560
891200
25,000

COMMERCIAL OUTLOT \$/ACRE

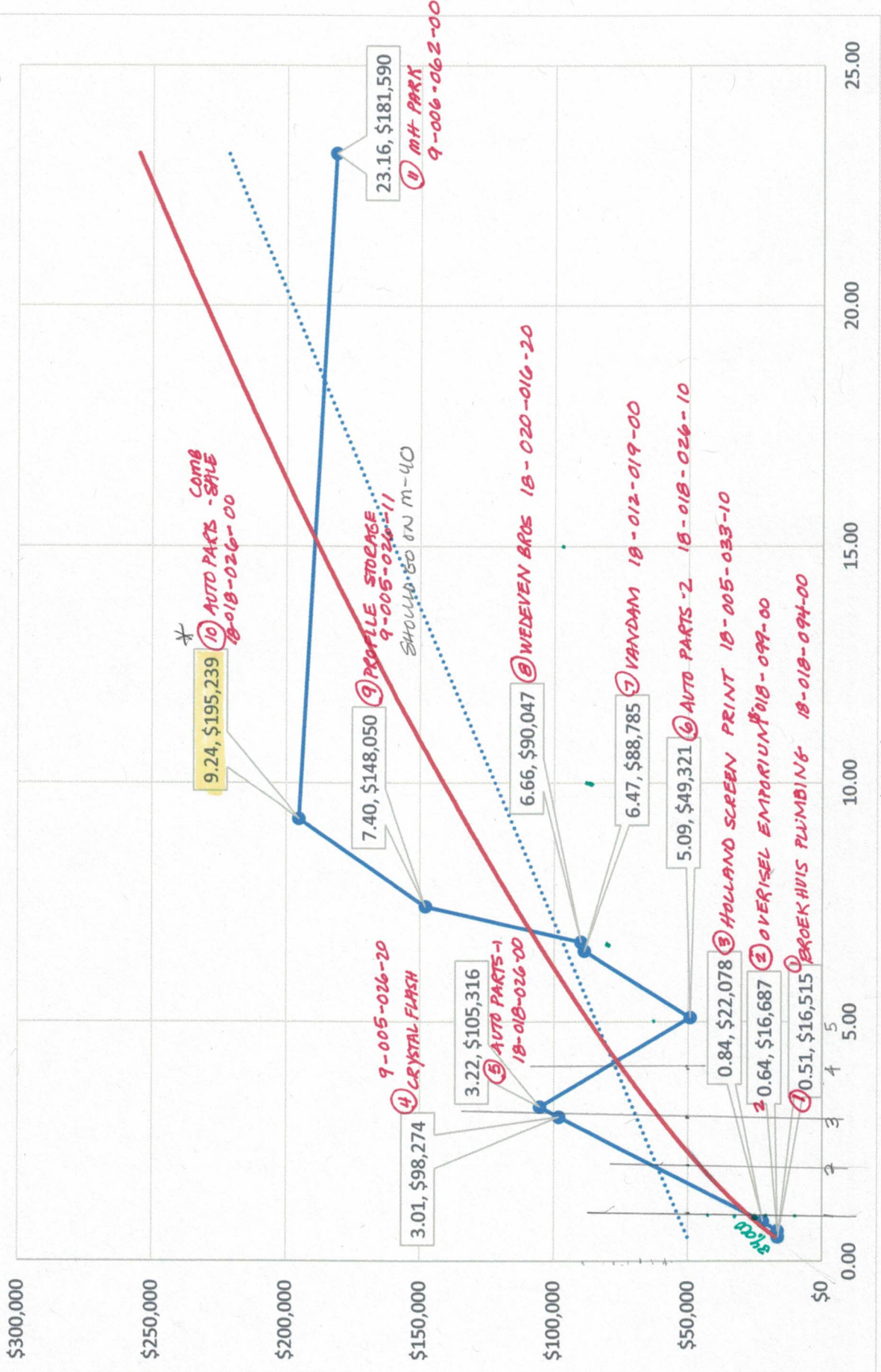

217,800 495,400 871,200 SF

* 1000 LUG PARTS 1021

* HIGHLIGHTED PARCEL IS SALE